



KITZ Corporation Of America  
800-772-0073 • www.KITZ.com

Cast Carbon Steel Check Valve  
Swing Type, Design - API 594, Wall Thickness - API 600, Bolted Cap,  
RFF per B16.5, BW per B16.25, LEV - 100 PPM max.,  
Body Materials - ASTM A216, A217, A352

Class **900**

## Cast Carbon Steel Check Valve

Bolted cover, Swing type disc.

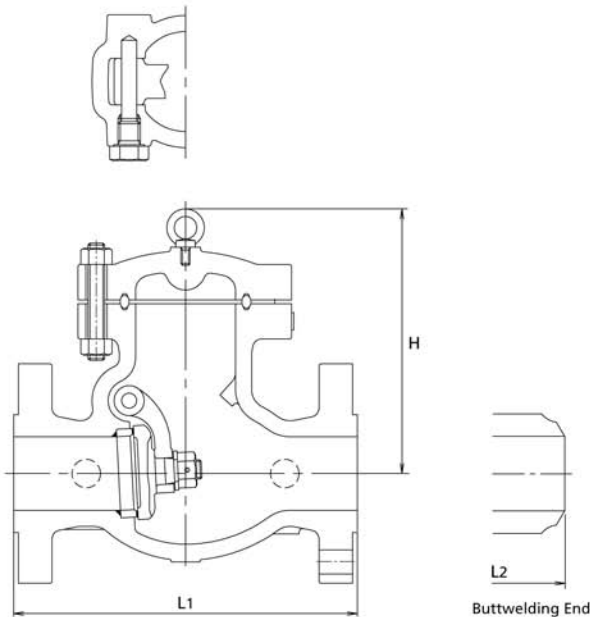

**900SCOS**

Fig	End Connections
<b>900SCOS</b>	RF-flanged ends.
<b>W900SCOS</b>	Butt-welding ends.

### Standard materials of parts

Parts	Materials
Body	ASTM A216 Gr.WCB
Cover	ASTM A216 Gr.WCB
Disc	ASTM A216 Gr.WCB+13Cr
Disc nut	ASTM A194 Gr.8
Body seat ring	Carbon Steel+HF*
Cover bolt/nut	ASTM A193 Gr.B7/A194 Gr.2H
Arm	ASTM A216 Gr.WCB
Gasket	See Page 6
Plug	ASTM A576 Gr.1045

\*Hard facing with Co-Cr-W Alloy.

Note: Refer to Page 3&6 for standard seat material and construction.

### Dimensions

Nominal Size		3	4	6	8	10	12	14	16	18	20
		80	100	150	200	250	300	350	400	450	500
L1	in	15.00	18.00	24.00	29.00	33.00	38.00	40.50	44.50	48.00	52.00
	mm	381	457	610	737	838	965	1029	1130	1219	1321
L2	in	15.00	18.00	24.00	29.00	33.00	38.00	40.50	44.50	48.00	52.00
	mm	381	457	610	737	838	965	1029	1130	1219	1321
H	in	11.5	13.6	17.5	20.7	24.4	28.3	31.3	34.6	37.5	41.0
	mm	292	346	444	526	620	720	794	880	952	1042